

BRYCO ARMS

'MODEL 59'

380 AUTO - 9MM - 40 S&W

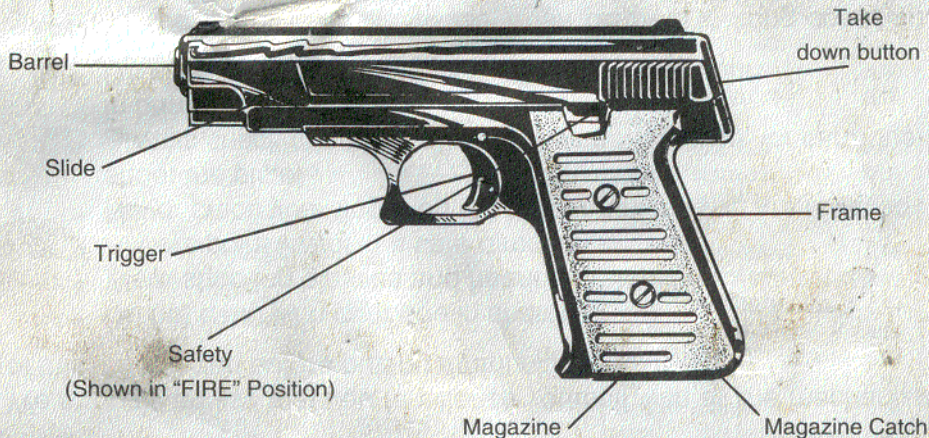

VERY IMPORTANT!

THESE INSTRUCTIONS SHOULD BE CAREFULLY READ AND NOTED.

ALL FIREARMS ARE DANGEROUS PLEASE BE CAREFUL

We strongly advise that you familiarize yourself with all the mechanism of this, or any gun before putting ammunition into it.

- Do not carry with cartridge in chamber
- Wear shooting glasses and hearing protection.
- Always point Pistol in a safe direction.
- Never place your finger on the trigger, unless you are ready to shoot the pistol.
- Always check chamber, after removing Magazine, for cartridge in barrel.
- Do not 'Dry Fire' (shoot pistol with empty chamber)

SAFETY: The word "FIRE" is visible when pistol is in firing condition. Moving the safety upwards, the word 'safe' is visible. When the pistol is in safe position the slide cannot be moved to chamber a cartridge and the trigger is inoperative.

LOADING THE PISTOL: After loading your Magazine, insert it into the bottom of the pistol handle and push it into the pistol as far as possible. When fully inserted, the Magazine Catch will hook on the Magazine and hold it in its proper position. Take the pistol in one hand with a firm grip, making sure your fingers are not touching the trigger. *Point Your Pistol in a Safe Direction* and pull the slide as far rearward as it will go. Release the Slide allowing it to go forward of its own accord. This procedure places the first cartridge into the chamber and the gun is ready for firing. Subsequent feeding and ejection operations are performed automatically until the pistol is empty.

UNLOADING WITHOUT FIRING: Always point your pistol in a safe direction. To unload unfired cartridges move the Magazine Catch rearward until the Magazine can be pulled from the pistol. After the Magazine is removed, pull the Slide to the rear to remove the cartridge from the barrel chamber. Always check the Barrel chamber visually for cartridges by holding the Slide back and looking into the Slide, Chamber and Magazine cavities.

DISASSEMBLY: *The pistol must be in unloaded, uncocked condition before take down can be performed.* To remove the Slide, use a blunt object to push the take down button, located in the back end of the Slide, forward until it stops (about 1/8 inch). While holding the take down button depressed, gently lift the Slide away from the frame until it stops. Release the take down button gently as it is springloaded. Hold the rear of the Slide up and push the Slide forward, off of the end of the gun. This procedure removes the entire Slide Assembly and is sufficient for normal cleaning and oiling. Clean the barrel within a reasonable period of time after shooting. After the powder residue has been removed, give the barrel bore a light protective coat of oil.

ASSEMBLY: Make sure the Recoil Spring/Shock Assy. is installed (under the barrel). Place the Slide Assembly over the Barrel and pull rearward until it can be dropped down onto the Frame. Depress the take down button into the Slide far enough to allow it to drop into its slot. Release the take down button after Slide is pushed down into the Frame. You should not be able to lift the rear of the slide from the frame if properly assembled. *After the assembly is completed, but before loading, manually operate the pistol to see that everything functions properly.*

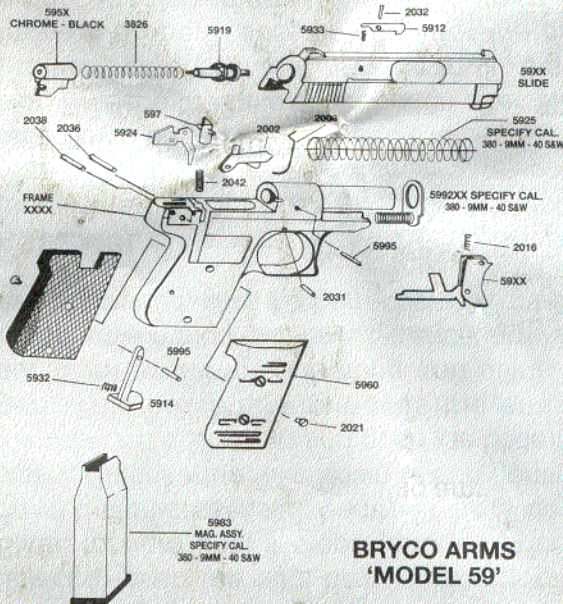

BRYCO ARMS 'MODEL 59'

PART	"59"	PRICE
XXXX	FRAME (NOT AVAIL)	
59XX	SLIDE	30.00
59XX	TRIGGER S/A	12.00
5914	MAG. CATCH	5.00
595X	TAKE DOWN BUTTON	6.00
5919	FIRING PIN	5.00
597	SEAR	8.00
5992XX	SHOCK ASSY	10.00
2002	SAFETY	5.00
5912	EXTRACTOR	5.00
5924	CAM	5.00
5983	MAG. ASSY	18.00
5960	BLACK GRIPS PAIR	10.00
5925	RECOIL SPRING	4.00
3826	FIRING PIN SPRING	4.00
2042	SEAR SPRING	2.00
5932	CATCH SPRING	2.00
2016	TRIGGER RET. SPR.	2.00
2003	SAFETY SPRING	4.00
5933	EXTRACTOR SPRING	2.00
2021	GRIP SCREWS	1.00 ^{ea}
5995	BARREL PIN	2.00
2038	TAKE DN CROSS PIN	2.00
2036	CAM PIVOT PIN	2.00
2031	TRIGGER PIVOT PIN	2.00
2032	EXTRACTOR PIN	2.00
5995	CATCH PIN	2.00

PARTS ORDERING INSTRUCTIONS

Changes in design may occur from time to time, always specify the color, serial number and caliber of your pistol with your order. Add \$2.00 Shipping & Handling

MAIL CHECK OR MONEY ORDER PAYABLE TO:

BRYCO ARMS
380 CLINTON ST.
COSTA MESA, CA 92626
(714) 252-7621

• CAUTION •

For your safety, and that of others, we strongly recommend that you do not place a cartridge in the barrel until you are ready to shoot it.

BE CAREFUL!